

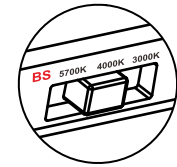

①

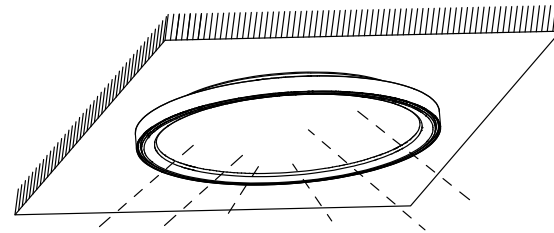

Wall Button CCT Change

Wall switch:

When use wall switch to operate, we must dial it to the BS button to operate, the factory default color temperature is 3000K. Press the wall switch once for 4000K, the second press for 5700K, the third press for off / on, then cycle operation.

②

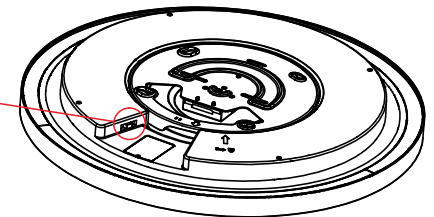
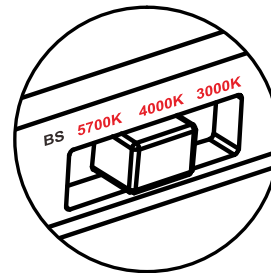

Toggle Switches

Factory default is 3000K. If you need to change the CCT, please toggle the CCT switch 5700K / 4000K / 3000K.



SMARTDECO

UP AND DOWN LIGHT, CEILING, WALL, PENDANT PANEL FIXTURE

Item No.	Dimension (mm)	Watt (W)	Voltage (V)	Lumens (lm)	PF	Function
SmartDeco-30W-TC-D	D330x41	30	AC220-240V	2500-2700	>0.9	Triac Dim CCT Settable
SmartDeco-40W-TC-D	D440x44	40	AC220-240V	3400-3700	>0.9	Triac Dim CCT Settable
SmartDeco-50W-TC-D	D540x44	50	AC220-240V	4100-4700	>0.9	Triac Dim CCT Settable

SMARTDECO

PLEASE READ INSTRUCTION BEFORE COMMENCING INSTALLATION AND RETAIN FOR FUTURE REFERENCES.
! Electrical products can cause death or injury, or damage to property. If in any doubt about the installation or use of this product, consult a competent electrician

-25°C < Ta < +40°C, 100-240V~50/60Hz, Class I, IP20

Installation

1. Ensure mains supply is switched off before commencing work.

Surface mounting:

2. Rotate counterclockwise to remove the bracket (P1)
3. Remove the terminal cover and mark the mounting hole (P2)
4. According to the mounting bracket, confirm the mounting position and fix it with screws (P3)
5. Power off first, then connect the wire L/N/GND to the terminal, and fix the terminal cover. (P4)
6. Aim the mounting bump of the lamp at the mounting port of the bracket and apply force upward.(P5)
At the same time, turn the lamp into the bracket clockwise.
7. The installation is complete (P6)

Pendant Installation

8. Rotate counterclockwise to remove the bracket (P7)
9. Remove the terminal cover and mark the mounting hole (P8)
10. According to the mounting bracket, confirm the mounting position and fix it with screws (P9)
11. Fix 4 lifting screws, fix 4 hanging ropes (P10)
12. First, fix the lamp to the lifting rope, and then connect the L/GND/N line to the corresponding L/GND/N in the terminale at the same time, turn the lamp into the bracket clockwise. (P11)
13. Install the bracket clockwise on the lamp, confirm stability, electrify completed. (P12)

Safety instruction

The luminaire may be covered with mineral wool thermal insulation of the type described in EN 13162:2015. If the installer wishes to use loose insulation or foam spray over insulation, they must use a bell shaped insulation cover over the luminaire. Although the fitting may be safely covered with insulation material, we recommend that the luminaire be abutted to but not covered with insulation material in order to maximise the lifetime of the luminaire. Luminaire lifetime can be maximised by maintaining as low an operating temperature as possible.

Warning

1. Please ensure surface is suitable and capable of holding the lamp weight
2. Do not operate if product is damaged
3. This product is not suitable for fire rated installations
4. The light source of this luminaire is not replaceable; when the light source reaches its end of life the whole luminaire should be replaced



Environmental Protection

Waste electrical products should not be disposed of with household waste. Please recycle where facilities exist.
Check with your Local Authority or retailer for recycling advice.

The Installation must be carried out by a qualified electrician

Surface-mounted

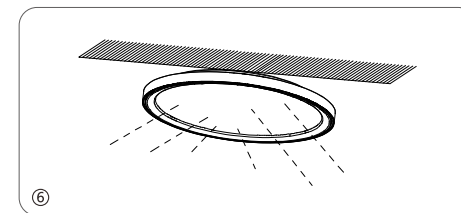
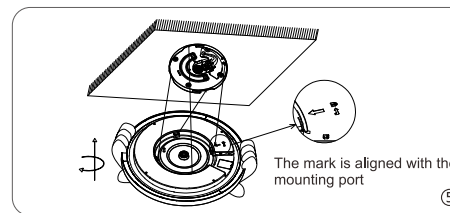
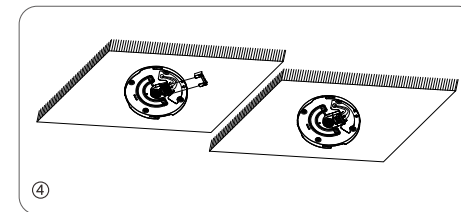
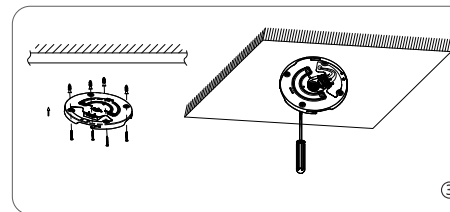
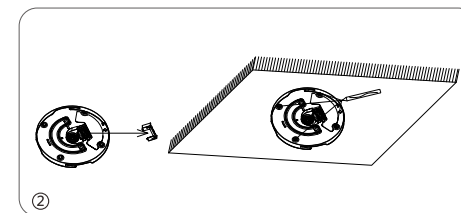
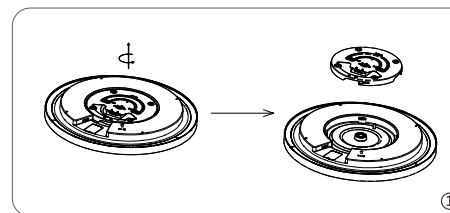

Pendant Installation

